

SALE - 1 (DRAWING FILE), 1:300 (IN PRINT COPY)

SITE PLAN

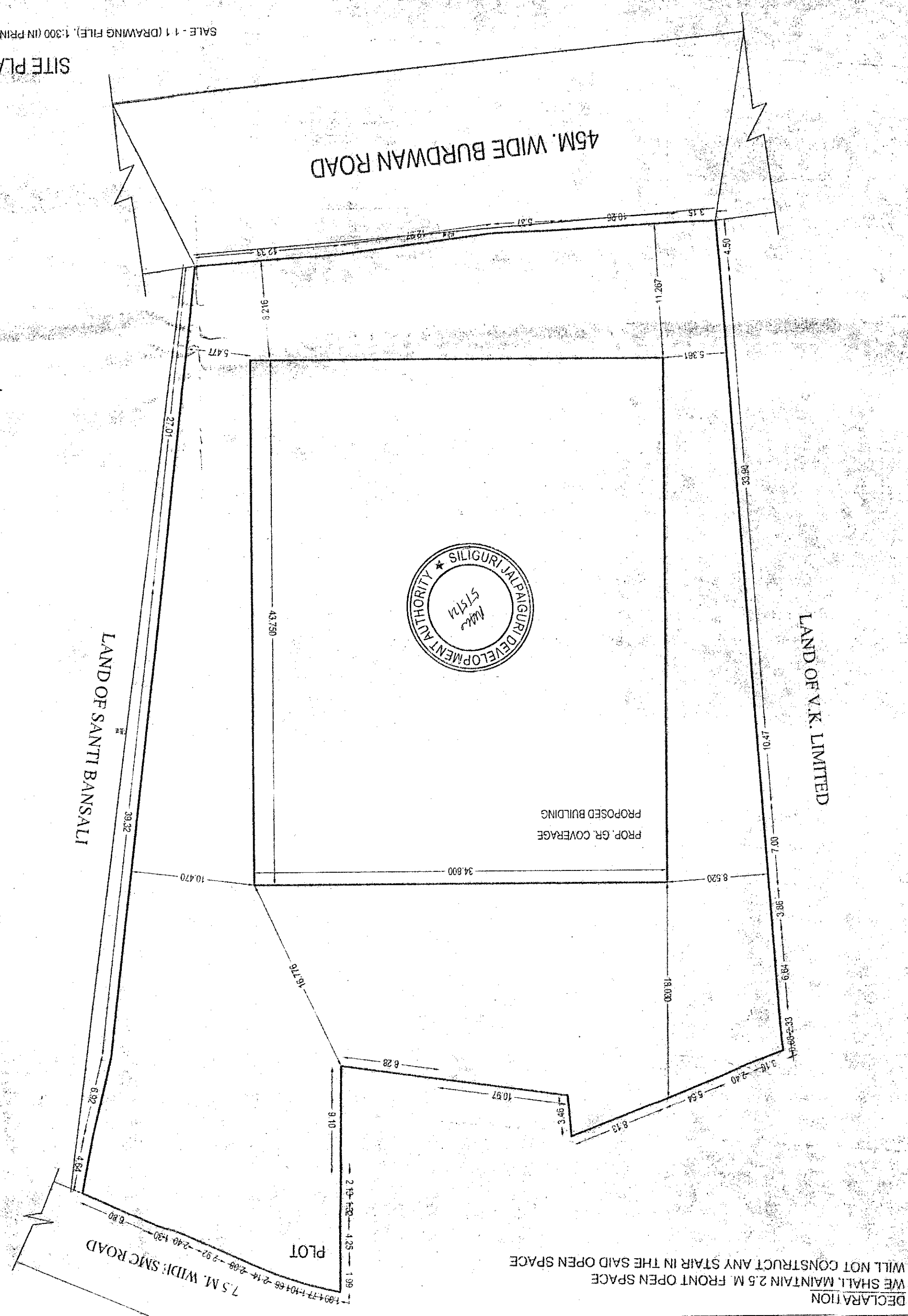

DECLARATION
WE SHALL MAINTAIN 2.5 M. FRONT OPEN SPACE
WILL NOT CONSTRUCT ANY STAIR IN THE SAID OPEN SPACE

FLOOR	COMMERCIAL AREA	RESIDENTIAL AREA	CAR PARKING AREA	COMMON AREA	TOTAL	REMARKS
BASMENT	1317.02 SQ.M.	1317.02 SQ.M.	1522.52 SQ.M.		4156.56 SQ.M.	
LOWER GR.	1317.02 SQ.M.	1317.02 SQ.M.	1522.52 SQ.M.		4156.56 SQ.M.	
1ST FLOOR	1317.02 SQ.M.	1317.02 SQ.M.	1522.52 SQ.M.		4156.56 SQ.M.	
2ND FLOOR	1317.02 SQ.M.	1317.02 SQ.M.	1522.52 SQ.M.		4156.56 SQ.M.	
3RD FLOOR	1317.02 SQ.M.	1317.02 SQ.M.	1522.52 SQ.M.		4156.56 SQ.M.	
4TH FLOOR	1317.02 SQ.M.	1317.02 SQ.M.	1522.52 SQ.M.		4156.56 SQ.M.	
5TH FLOOR	1317.02 SQ.M.	1317.02 SQ.M.	1522.52 SQ.M.		4156.56 SQ.M.	
6TH FLOOR	1317.02 SQ.M.	1317.02 SQ.M.	1522.52 SQ.M.		4156.56 SQ.M.	
TOTAL AREA	10356.16 SQ.M.				10356.16 SQ.M.	

PRITAM DEY (B. Arch.)
Consulting Architect
CA/2006/39076
E-Mail ID - subhrajitenghncr@gmail.com
S.M.C. Emparment Number - 73
S.S. Colony, 4th Main No - 96306034
ER. Subrata Majhi
Licensed Building Surveyor of
S.M.C. Emparment Number - 73
S.S. Colony, 4th Main No - 96306034

Mech Industries Pvt. Ltd.
AS A CONSTITUTED ATTORNEY OF
MECH INDUSTRIES PVT. LTD.
SIGNATURE OF OWNER

